



34.5×32.5×34

NVF4-6

Features

- Small size.
- Contact load capacity up to 150A.
- Suitable for automobile.
- Terminal types as inserting.

Ordering Information

NVF4-6 C Z 50 a DC12V N D
 1 2 3 4 5 6 7 8

1 Part number: NVF4-6
 2 Contact arrangement: A:1A; C:1C
 3 Enclosure: S: Sealed type; Z: Dust cover;
 4 Contact Current: 50A,80A,100A,150A;
 5 Terminals: a: plug in type

6 Coil rated voltage(V): DC:12,24
 7 Contact material: N:AgNi; NIL: AgSnO₂
 8 Coil transient suppression: D: with diode.;
 2D:with two diodes.;
 R: with resistance.;
 DR: with diode and resistance;
 NIL: standard

Contact Data

Contact Arrangement	1A (SPSTNO) ,1C (SPDT(B-M))		
Contact Material	AgSnO ₂ , AgNi		
Contact Rating (resistive)	1A		1C
	100A,150A/12VDC 50A/24VDC	NO: 50A/24VDC,100A,150A/12VDC NC: 50A/24VDC,80A,100A/12VDC	
Max. Switching Power	1800W		
Max. Switching Voltage	75VDC	Max. Switching Current:150A	
Contact Resistance or Voltage drop	≤30mΩ ≤200mV (at Contactrating)		Item 4.12 of IEC 61810-7
Operation life	Electrical	10 ⁵	Item 4.30 of IEC 61810-7
	Mechanical	10 ⁷	Item 4.31 of IEC 61810-7

Coil Parameter

Dash numbers	Coil voltage VDC		Coil resistance Ω ±10%	Pickup voltage VDC(max) (65%of rated voltage)	Release voltage VDC(min) (10% of rated voltage)	Coil power consumption W	Operate Time ms	Release Time ms
	Rated	Max.						
012-2900	12	15.6	50	7.8	1.2	2.9	≤10	≤5
024-2900	24	31.2	195	15.6	2.4			

CAUTION: 1.The use of any coil voltage less than the rated coil voltage will compromise the operation of the relay.
 2.Pickup and release voltage are for test purposes only and are not to be used as design criteria.

Operation condition

Insulation Resistance ¹⁾	100MΩ min (at 500VDC)	Item 7 of IEC 60255-5
Dielectric Strength ¹⁾		
Between contacts	50Hz 750V	Item 6 of IEC 60255-5
Between contact and coil	50Hz 1000V	Item 6 of IEC 60255-5
Shock resistance	147m/s ² 11ms	IEC 68-2-27 Test Ea
Vibration resistance	10Hz~40Hz double amplitude 1.5mm	IEC 68-2-6 Test Fc
Terminals strength	30N	IEC 68-2-21 Test Ua2
Solderability	235°C ±2°C 3s±0.5s	IEC 68-2-20 Test Ta method 1
Ambient Temperature	-40°C~125°C	
Relative Humidity	85% (at 40°C)	IEC 68-2-3 Test Ca
Mass	65g	

Note: 1). When testing, coil terminals should be connected, If coil transient suppression is installed in relay .

Dimensions

mm /inch

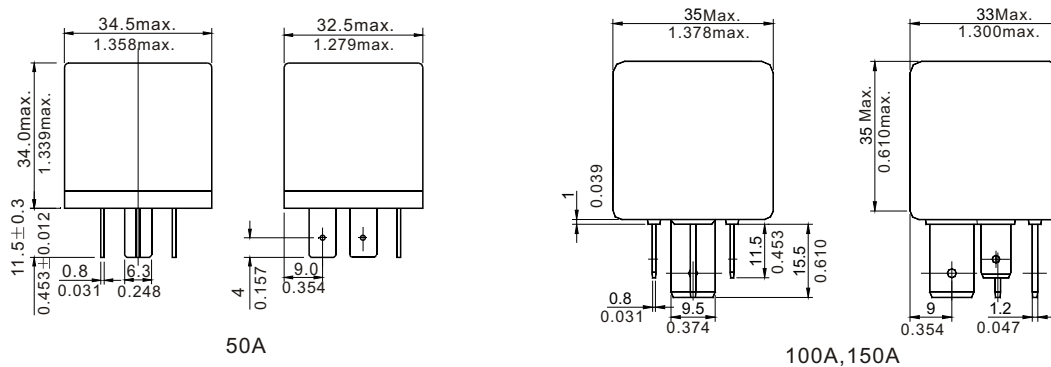

Dimensions

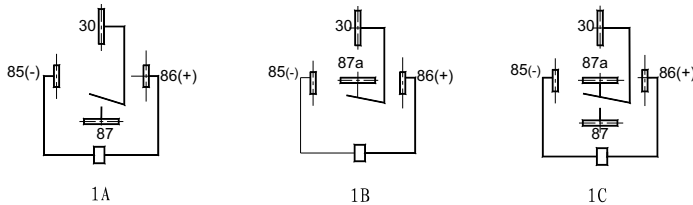

Wiring diagram (Bottom view)

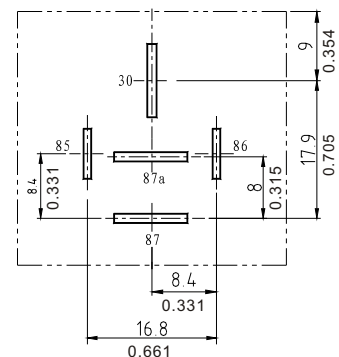

Mounting (Bottom view)

NOTES 1). Dimensions are in millimeters.
2). Inch equivalents are given for general information only.